

Dealer: _____
 Color: _____
 Customer: _____

8 X 17 RV Standard Frame ~ 2016

Order Date: _____

- Single Axle Frame
- Hand Crank Winch System
- SS Cables
- 6 Holes with Lights
- Digital TV Antenna
- Wire for Portable Satellite
- Radio w/4 speakers
- 12V Kill Switch
- 12V Recepts
- 110V Recepts
- 2 ~ 110V Lights
- Cedar Interior
- TV Shelf
- Full bath w/toilet & shower
- 3 Burner cook-top w/oven
- Range hood w/vent
- Double sink
- Microwave
- Small refrigerator
- Raised Panel Doors
- Flat Ceiling
- Camo cushions & curtains
- A/C
- 30,000 BTU Furnace
- 2 ~ 30" Bunks
- 30" Dinette
- 48" Dinette
- RV Door
- Bay Window
- Bay Seat Cushion
- 14' Power Awning

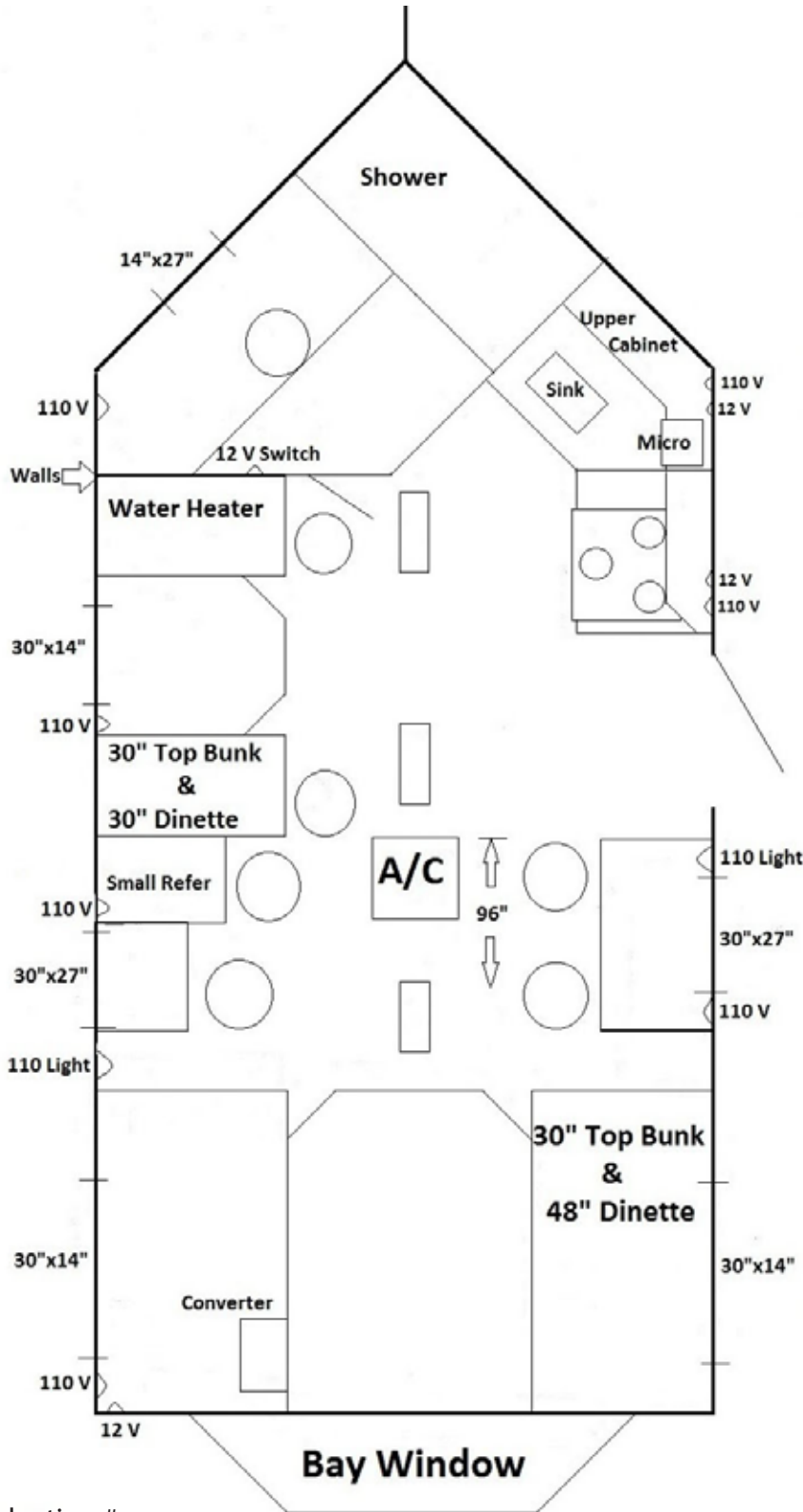

Production # _____